

KTS TESTA SVASATA CORPO CILINDRICO LISCIO

CH-RB COUNTERSUNK HEAD ROUND BODY PLAIN

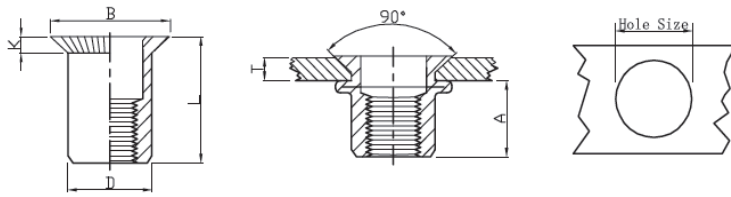

Unit: mm

THREAD	P/N	LD P/N	T (grip range) Min Max	A Ref	Hole size +0.10	D +0.07 -0.1	B +/-0,3	K +/- 0,2	L +/- 0,3
M4	CH-RB-0430	KTSM4C1	1.5-3.0	6,5	6,0	5,9	9,0	1,5	12,0
M5	CH-RB-0535	KTSM5C1	1.5-3.5	7,5	7,0	6,9	10,0	1,5	13,0
M6	CH-RB-0640	KTSM6C1	1.5-4.0	9,0	9,0	8,9	12,0	1,5	15,5
M8	CH-RB-0845	KTSM8C1	2.0-4.5	11,0	11,0	10,9	14,0	1,5	18,5
M10	CH-RB-1050(13H)	KTSM10C1/13	2.0-5.0	13,0	13,0	12,9	16,0	1,5	21,0

KTSZ TESTA SVASATA CORPO CILINDRICO ZIGRINATO

CH-KB COUNTERSUNK HEAD KNURLED BODY

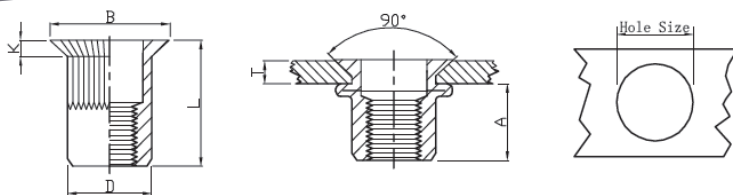

Unit: mm

THREAD	P/N	LD P/N	T (grip range) Min Max	A Ref	Hole size +0.10	D +0.07 -0.1	B +/-0,3	K +/-0,2	L +/-0,3
M3	CH-KB-0325	KTSZM3C1	1.5-2.5	4,5	5,0	4,9	7,5	1,5	9,5
M4	CH-KB-0430	KTSZM4C1	1.5-3.0	6,5	6,0	5,9	9,0	1,5	12,0
M4	CH-KB-0450	KTSZM4L1	3.0-5.0	6,5	6,0	5,9	9,0	1,5	13,0
M5	CH-KB-0535	KTSZM5C1	1.5-3.5	7,5	7,0	6,9	10,0	1,5	13,0
M5	CH-KB-0550	KTSZM5L1	3.5-5.0	7,5	7,0	6,9	10,0	1,5	15,0
M6	CH-KB-0640	KTSZM6C1	1.5-4.0	9,0	9,0	8,9	12,0	1,5	15,5
M6	CH-KB-0660	KTSZM6L1	4.0-6.0	9,0	9,0	8,9	12,0	1,5	17,0
M8	CH-KB-0845	KTSZM8C1	2.0-4.5	11,0	11,0	10,9	14,0	1,5	18,5
M8	CH-KB-0860	KTSZM8L1	4.5-6.0	11,0	11,0	10,9	14,0	1,5	19,0
M10	CH-KB-1050(13H)	KTSZM10C1/13	2.0-5.0	13,0	13,0	12,9	16,0	1,5	21,0
M10	CH-KB-1065(13H)	KTSZM10L1/13	5.0-6.5	13,0	13,0	12,9	16,0	1,5	24,0
M12	CH-KB-1250(16H)	KTSZM12C1/16	2.0-5.0	16,5	16,0	15,9	19,0	1,5	24,0
M12	CH-KB-1270(16H)	KTSZM12L1/16	5.0-7.0	16,5	16,0	15,9	19,0	1,5	27,5